



Session 1.4

Designing Games in Strategic Form

This is a set of instructions for designing the strategic form with a matrix representation.

Opening a strategic form game

1. Click on **Design** window.
2. Click on  (new definition) and select "Strategic Form Game"
3. By default two player 2x2 matrix is created.

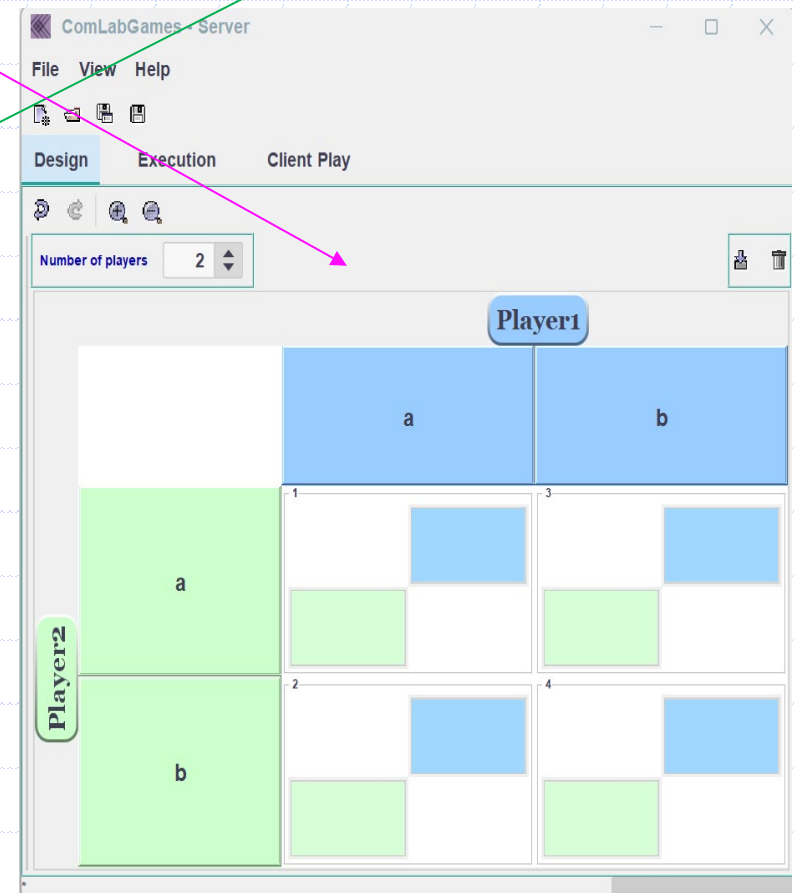
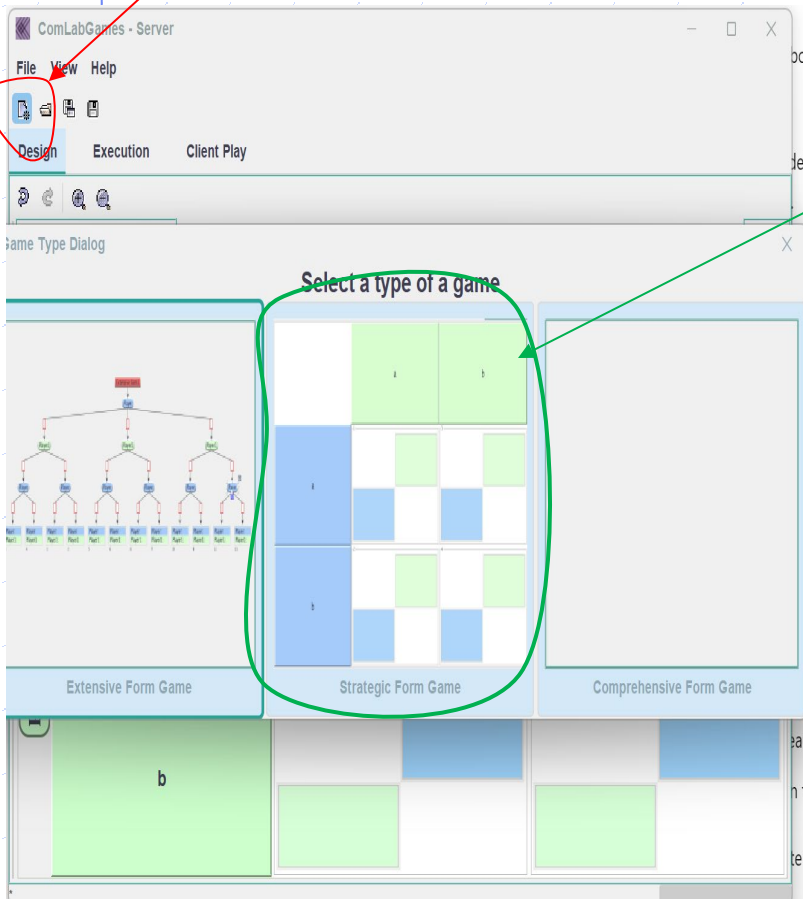

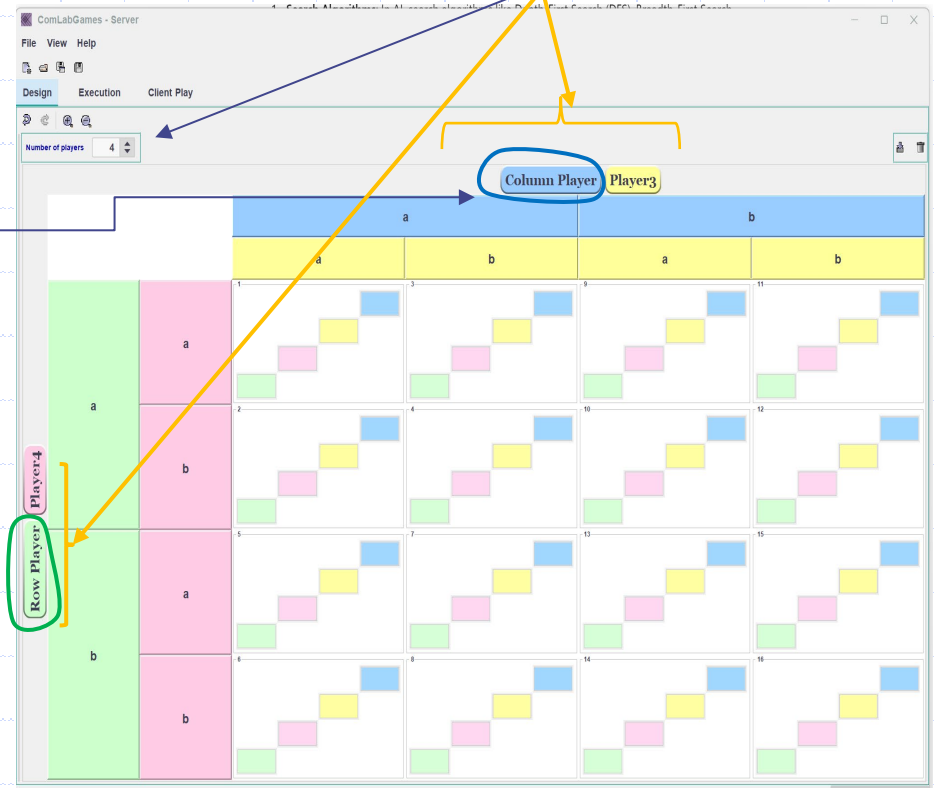
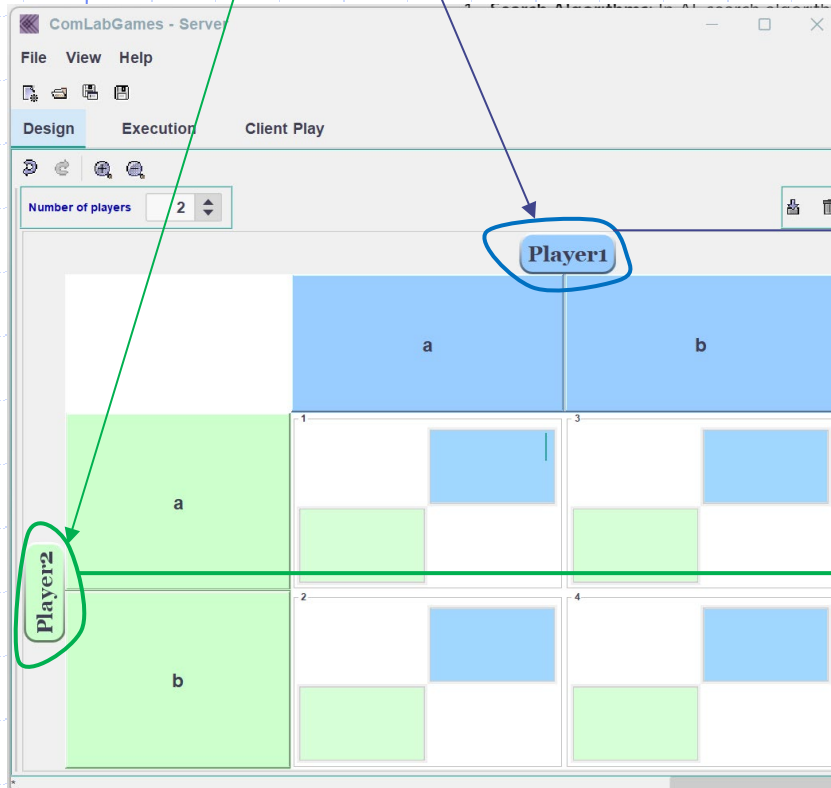

Designing a strategic form game

1. To *rename* players, double click on **Player1** / **Player2** and rename it (for example to: **Column Player** and **Row Player**).
2. To *increase* number of players, select the number of players from **Number of players** 2 to up to four: **Number of players** 4



Adding and deleting rows and columns

- 1. To add a row or a column, drag and drop  on any row/column you want to add.
- 2. To delete a row or a column, drag and drop  to the row/column you want to delete. Repeat a process to delete another row/column.

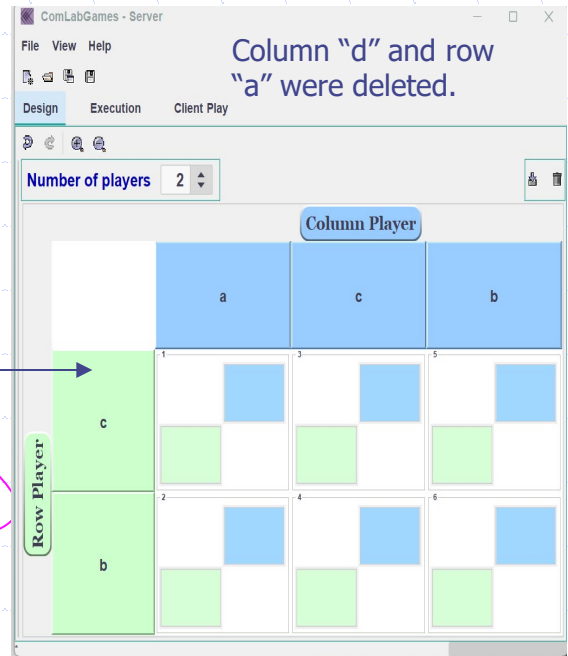
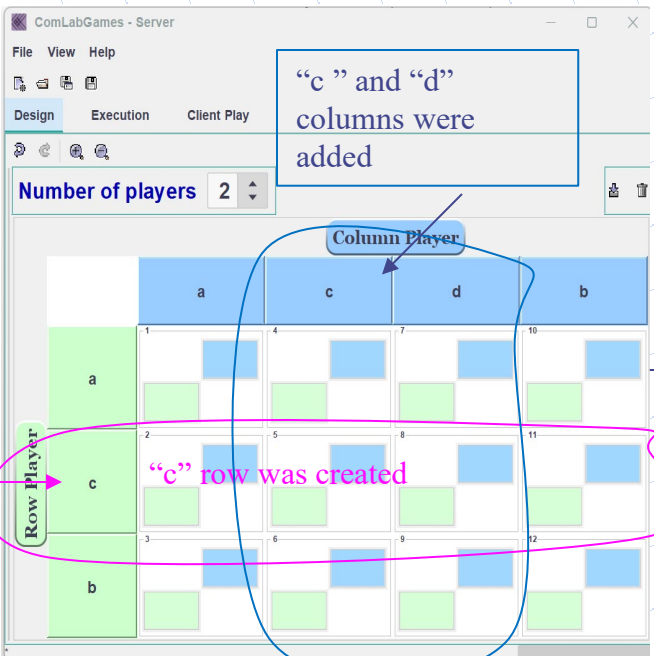

Labeling and reordering strategies

1. Double click on a strategy and rename it.
2. To reorder a strategy, drag and drop a strategy to the desired place.

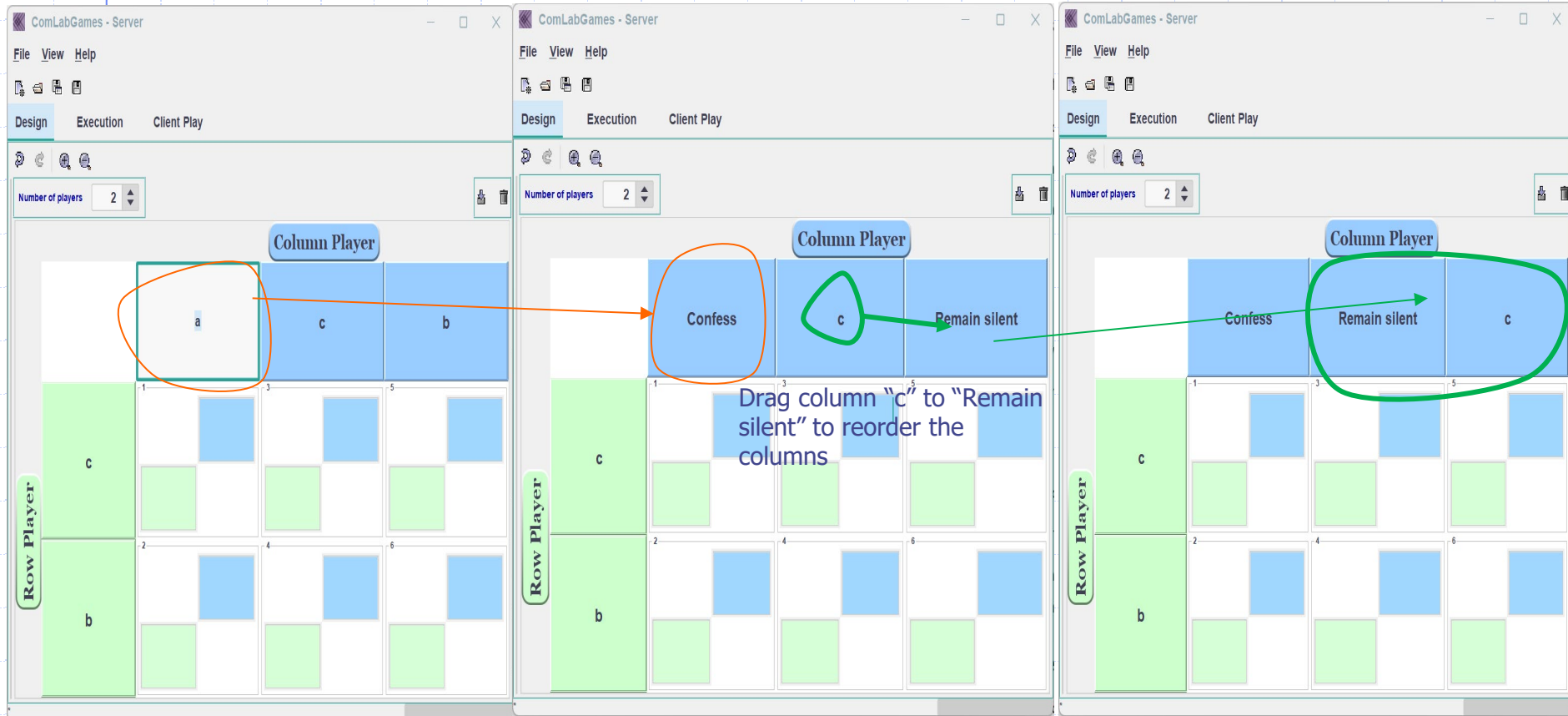

Editing payoffs

1. By default all payoffs are set to zero. Subjects will see zero payoffs if they are not edited.
2. To change a payoff, write a number or a formula in the payoff cell and make sure to click "Enter" to confirm each payoff so the red rectangle around payoffs disappear.

ComLabGames - Server

File View Help

Design Execution Client Play

Number of players 2

Column Player

	Confess	Remain silent
Confess	1 -4 -4	3 -6 0
Remain silent	2 0 -3-3	4 -1 -1

Row Player

Subjects will see -6

ComLabGames - Server

File View Help

Design Execution Client Play

Number of players 2

Column Player

	Confess	Remain silent
Confess	1 -4 -4	3 -6 0
Remain silent	2 0 -3-3	4 -1 -1

Row Player